

High Efficiency Sample Introduction System for ICP-MS (HE-SIS)

Single-cell analysis by ICP-MS (SC-ICP-MS) is enhancing the basic understandings in cellular biology, oncology and drug discovery. SC-ICP-MS provides quantification of metals in individual biological cells at ultra-low detection levels not previously seen in other techniques. SC-ICP-MS can be used to study disease aetiology, provide a better understanding of diseased cell states and develop new drug treatments for better patient outcomes.

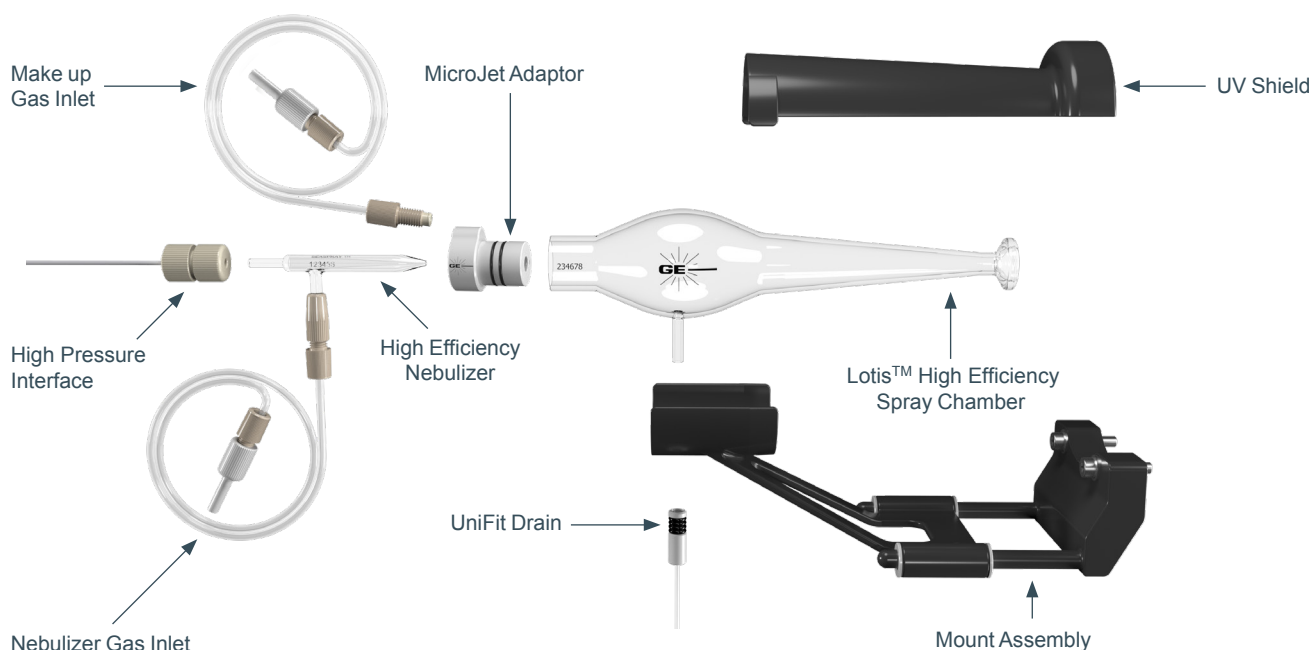

The Glass Expansion High Efficiency Sample Introduction System (HE-SIS) for consists of a:

- MicroMist™ High Efficiency, low uptake rate, concentric glass nebulizer designed to efficiently nebulize single-cell suspensions without compromising cell integrity
- Lotis™ High Efficiency spray chamber directly coupled to the ICP-MS for the highest transport efficiency of the nebulized cell suspension
- Patent pending MicroJet gas adapter shapes the nebulizer aerosol plume to reduce cell deposition on the spray chamber walls, enhancing the transport efficiency

In single-cell analysis, the aim of the sample introduction system is to convert a continuous stream of cell suspension efficiently into an aerosol made entirely of single cells into the analytical plasma. Critically, during the nebulization process the cells must remain intact and unruptured, to ensure each individual cell provides a single burst of ions in the plasma which can be measured by the mass analyser of the ICP-MS.



GLASS EXPANSION
Quality By Design

Asia Pacific

6 Central Boulevard,
Port Melbourne, Vic 3207,
Australia
(61) 3 9320 1111
enquiries@geicp.com

Americas

31 Jonathan Bourne Drive,
Unit 7 Pocasset, MA 02559,
USA
508 563 1800
geusa@geicp.com

Europe

Friedenbachstrasse 9,
35781 Weilburg,
Germany
+49 6471 3778517
gegmbh@geicp.com

Lotis™ High Efficiency Spray Chamber with MicroJet Adaptor



Conventional ICP-MS spray chambers have low transport efficiencies (< 5%) and filter out larger droplets (>5µm) preventing a high percentage of cells from entering the plasma. As most cell lines of interest are larger than 5µm, the spray chamber design for single cell analysis is different from conventional ICP-MS spray chambers.

The Lotis™ High Efficiency Spray Chamber with the patent pending MicroJet Adaptor to simultaneously provide a:

- On-axis, laminar high transmission efficiency spray chamber
- High velocity sheathing gas entraining and shaping the nebulizer aerosol plume to prevent cell deposition on the spray chamber walls
- Excellent washout between samples

High Efficiency MicroMist™ Nebulizer



The novel design of the high efficiency nebulizer used in the Glass Expansion HE-SIS system uses a low argon gas flow to provide high nebulization efficiency without rupturing the cell walls.

Glass Expansion's high efficiency nebulizer with proprietary VitriCone sample channel features:

- Superb transport efficiency at low sample uptake rates (15 to 45 µL/min) to ensure individual intact cells are transported into the plasma for measurement
- Constant diameter, large bore sample channel minimizes blockages from sample build-up commonly experienced with biological samples
- Rigid, precision machined thick-walled glass sample capillary gives the best analytical precision by resisting harmonic vibrations from the high linear velocity of the surrounding argon gas flow
- Inert, metal-free DC gas fittings with ratchet mechanism give reliable, reproducible leak-free Ar connections
- Easy to use, gas tight, zero dead volume sample fittings make connecting to the sample delivery system easy and reliable

Specifications

Nebulizer	Low gas, high-efficiency concentric glass nebulizer
Spray Chamber Material	Borosilicate glass
Make-up Gas Addition	Inert MicroJet Adapter with 0.01 to 1 L/min flow rate range
Sample interface	Zero dead volume PEEK nebulizer connector

For more information please visit www.geicp.com or contact us at enquiries@geicp.com.



GLASS EXPANSION
Quality By Design